



A ground floor maisonette, For Sale To Landlords Only, being sold with tenants in occupation. This home offers in brief, front entrance door leading into the hallway, with lounge diner, fitted kitchen with fitted units, built-in oven and hob, and uPVC back door to the garden and window overlooking the garden. There are two good sized double bedrooms and a fitted bathroom with a three piece white bathroom suite with shower positioned above the bath.

The home is uPVC double glazed and gas centrally heated via the gas fired combination boiler. Outside is an enclosed rear garden, purpose built outbuilding for storage. This property is ideal for the investor, currently with tenant in occupation paying £650 pcm. as of Jan 2026. Being situated within a popular residential location, ideal for families. The property is conveniently located for Burton town centre and is within a commutable distance of the A38 linking major road networks.

Viewings strictly appointment only.

## The Accommodation

### Hallway

Lounge  
13'11 max x 13'6 m,ax

Kitchen  
9'8 x 8'6

Bedroom One  
13'8 x 10'0

Bedroom Two  
11'10 x 9'6

Bathroom  
6'6 x 5'6

### Rear Garden & Outbuilding

#### Leasehold

The freehold is owned by Trent & Dove Housing and was issued 124 year lease on 18/11/1990. The ground rent and charge is £165.66 (for 2025) per year and reviewed in March every year. The above is subject to change.

Property construction: Standard

Parking: None

Electricity supply: Mains

Water supply: Mains

Sewerage: Mains

Heating: Mains Gas

Council Tax Band: A

Local Authority: East Staffordshire Borough Council

Broadband type: TBC - See Ofcom link for speed:

<https://checker.ofcom.org.uk/> Mobile signal/coverage:

See Ofcom link <https://checker.ofcom.org.uk/>

Useful Websites:

[www.gov.uk/government/organisations/environment-agency](http://www.gov.uk/government/organisations/environment-agency)

An on-site management fee may apply to all modern or new developments.

Please ensure that you have viewed the agent's full PDF brochure for full details of the property, and do not rely on third party websites or advertisements for full information of the home before instruction of a solicitor/ conveyancer on the purchase of the property. The property information provided by Nicholas Humphrey Estate Agents is based on enquiries made of the vendor and from information available in the public domain. If there is any point on which you require further clarification, please contact the office and we will be pleased to check the information for you. Please note if your enquiry is of a legal or structural nature, we advise you to seek advice from a qualified professional in their relevant field.

Draft details awaiting vendor approval and subject to change





### First Floor

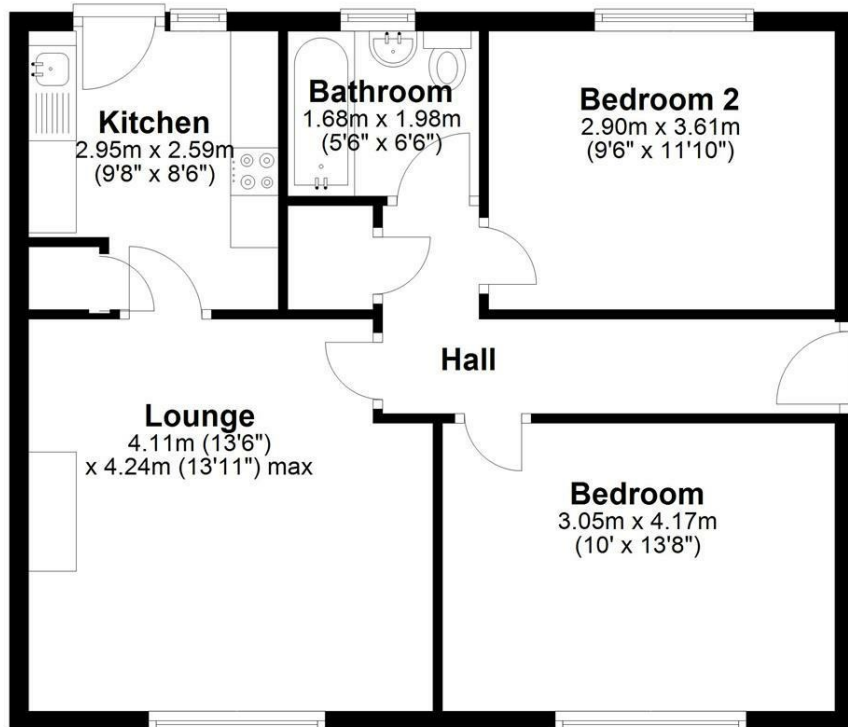

NICHOLAS HUMPHREYS. This Floorplan is for illustrative purposes only and while reasonable efforts have been made to ensure its accuracy, it is not to scale and measurements should not be relied upon. For display and layout purpose only used by NICHOLAS HUMPHREYS, as a general indication of the layout. It does not form any part of any contract or warranty.

Plan produced using PlanUp.

## Energy Efficiency Rating

	Current	Potential
Very energy efficient - lower running costs		
(92 plus) <b>A</b>		
(81-91) <b>B</b>		
(69-80) <b>C</b>	<b>73</b>	<b>76</b>
(55-68) <b>D</b>		
(39-54) <b>E</b>		
(21-38) <b>F</b>		
(1-20) <b>G</b>		
Not energy efficient - higher running costs		
<b>England &amp; Wales</b>	EU Directive 2002/91/EC	



## Council Tax Band A Leasehold

**Services.** If & where stated in the details main's water, gas and electricity are understood to be available to the property, none of these have been tested or investigated for connection, nor any of the appliances attached thereto, have been tested by Nicholas Humphreys, who gives no warranties as to their condition or working order.

**Floor Plans.** To be used as an illustrative purpose only and while reasonable efforts have been made to ensure its accuracy, it is not to scale and measurements should not be relied upon. The company displays the floor plan as a general indication of layout and it does not form any part of any contract or warranty and provides an approximate guide to layout.

**Money Laundering.** Under the Protecting Against Money Laundering and Proceeds of Crime Act 2002, we must point out that any successful purchasers proceeding with the purchase will be asked for identification ie: Passport, Driving Licence, and recent Utility Bill. This evidence will be required prior to solicitors being instructed in the purchase of a property.

**Survey.** We advise all buyers to undertake their own investigations into the condition of the property and surroundings by an independent survey. We the Agent do not conduct a survey of the property and cannot advise on structural defects or materials used. Independent advice is required before exchange and completion.

**Agent Note.** Whilst every care has been taken in preparation of these details, they are for guidance purpose only. All measurements are approximate, and whilst every care has been taken for accuracy, their accuracy should not be relied upon. Buyers are advised to recheck measurements and inspect the property before exchange of contracts to confirm they are satisfied with the condition of the property and surroundings before completion of the purchase. New development sites are increasingly implementing an on-site annual management charge, all sale of property could be subject to this charge, to be verified & confirmed by your acting solicitor/ conveyancer before exchange of contracts.

**Selective License Areas.** The Council's Selective Licensing Scheme requires all landlords who privately rent out properties within the designated areas to obtain a licence from the council. Within Burton on Trent the following streets have been designated: Blackpool Street, Branston Road, Broadway Street, Goodman Street, King Street, Queen Street, Shobnall Street, Uxbridge Street & Waterloo Street. A license fee for application will be payable and work to the home maybe required. Full information: <https://www.eaststaffsbc.gov.uk/housing-and-property/landlords/selective-licensing-scheme>

**01283 528020**  
NICHOLASHUMPHREYS.COM

183 High Street, Burton upon Trent, Staffordshire, DE14 1HN